

TECHNOLOGY IN MOTION

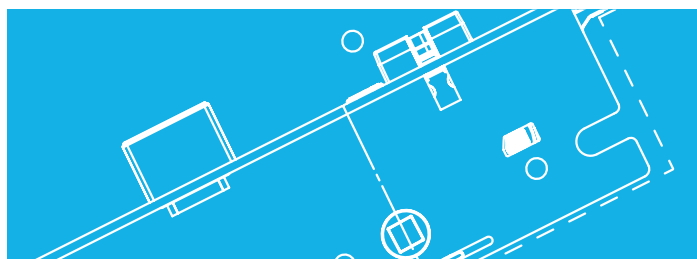

MACO PROTECT DOOR LOCKS

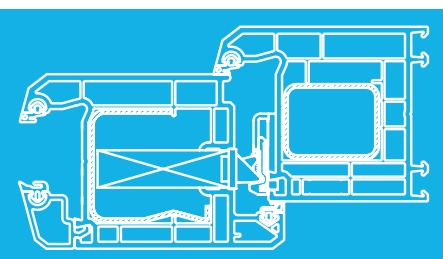

C-TS Combined Door Locks
PVC, Timber & Composite

ASSEMBLY INSTRUCTIONS



Legend

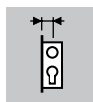

Backset BS

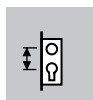

Spindle centres SC



Handle height HD

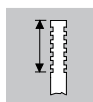

Cropping range



Sash height



Profile front edge



Contents

Protection in transport	4
Operating instructions	5
Installation advice	8
Main-lock casing routing	11
Drilling and routing hole-patterns	12
Positioning the striker plates	14



Protection in transport

Simple transport protection devices, wedges or blocks should be used when transporting the doors as a whole unit.

Ⓐ Protection in transport

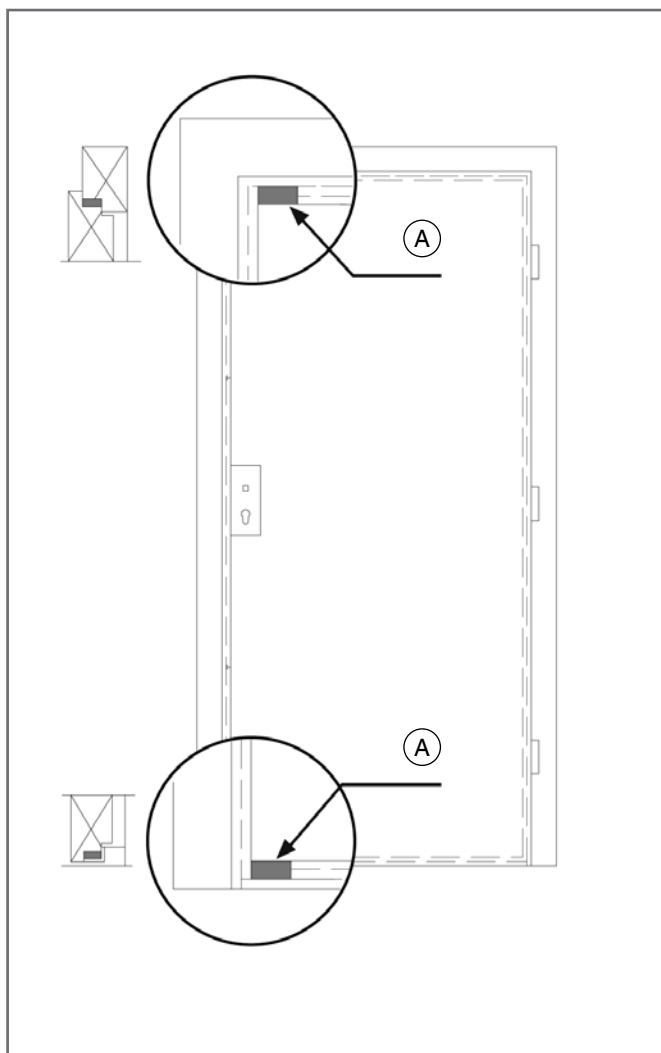

Operating instructions

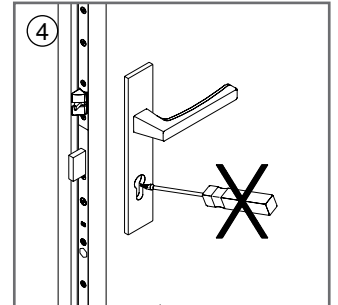
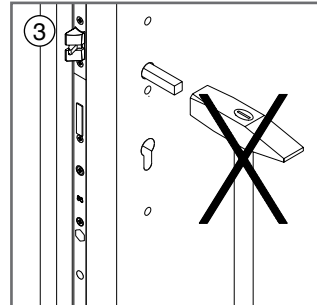
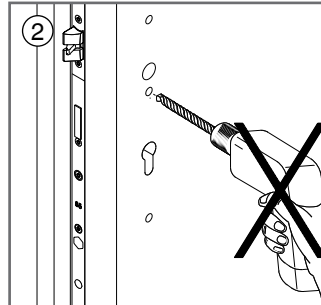
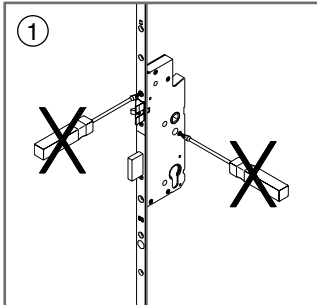

- ① On no account should the main lock casing be opened!
- ② Carry out all drilling work before installing the lock!
- ③ Do not hammer the handle spindle bar forcibly through the spindle receiver!
- ④ Only lock the door lock with the appropriate universal access key!

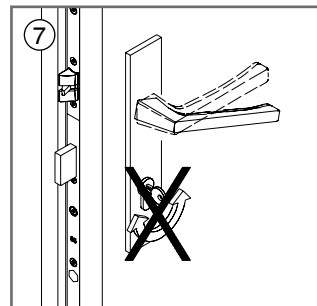
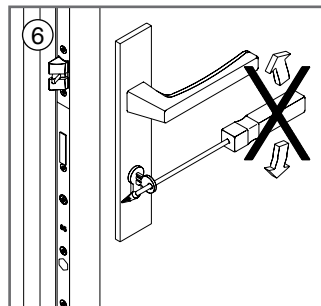
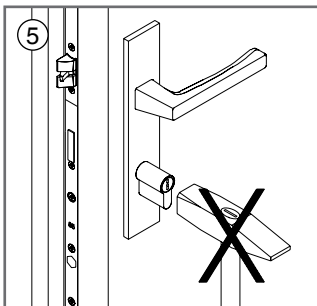

- ⑤ Do not use force when installing the cylinders!
- ⑥ Do not apply force through external leverage in order to turn the key!
- ⑦ The handle and the key may not be operated simultaneously!

Operating instructions

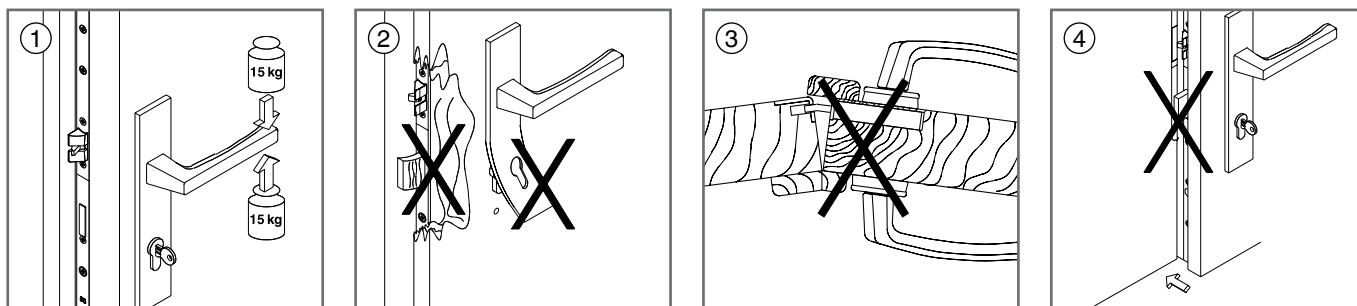

- ① Apply a maximum force of 15Kg in the operation direction (on the lever handle)
- ② As soon as traces of the use of force are visible, the lock must be replaced
- ③ On double doors, the active door must be opened before the passive door
- ④ Ensure the dead bolt is not protruding when the door is open!

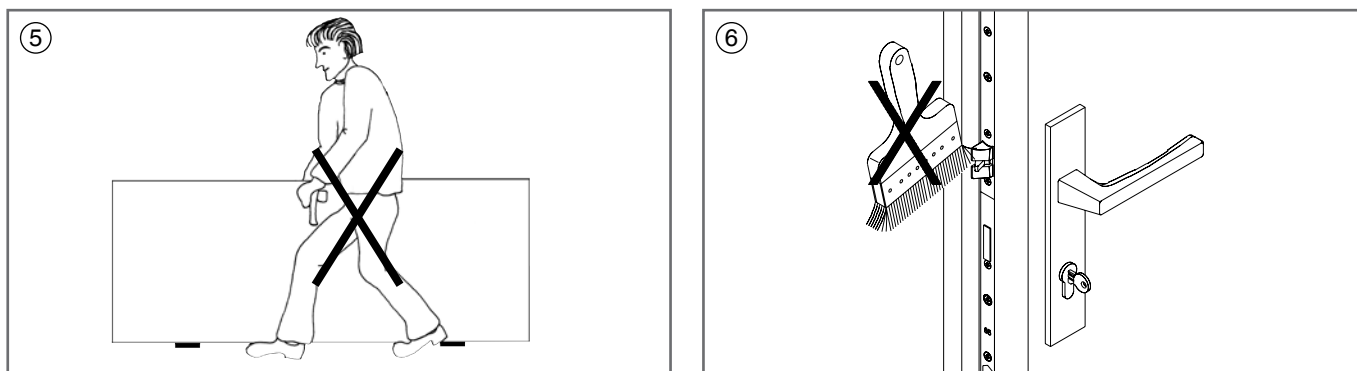

- ⑤ Do not carry the door by the handle!
- ⑥ Do not paint or varnish over the lock's deadbolt and latch

Operating instructions

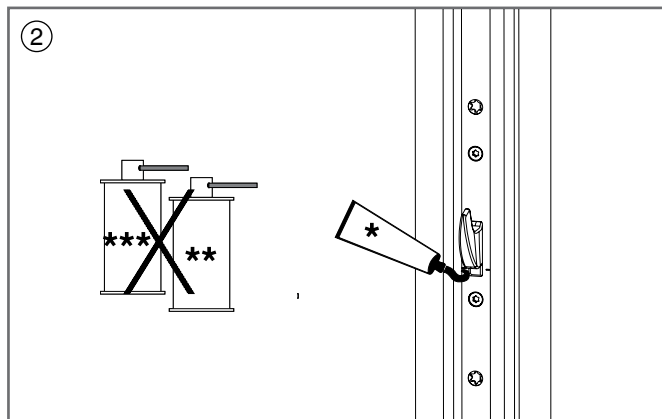
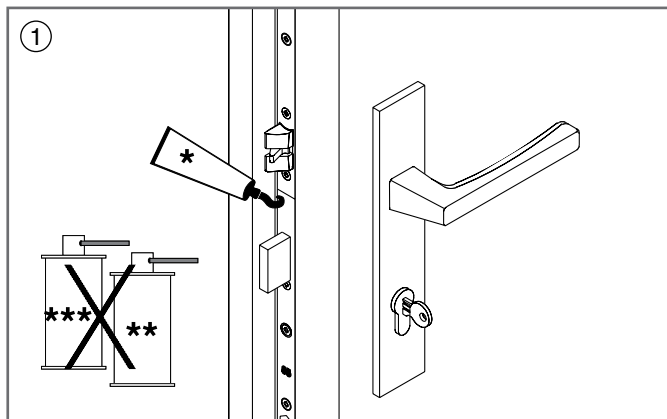

* Grease

** Rust dissolver

*** Silicone spray



Do not use lube oils,
rust removers, silicone
sprays, WD40 etc....!!

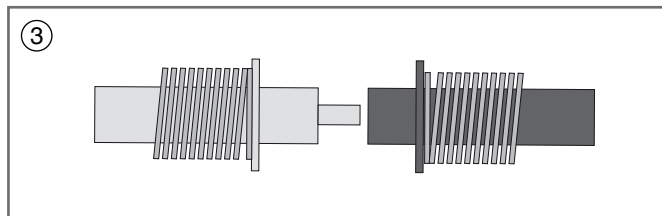

- ① The door lock (main lock casing) is supplied with a high performance lubricant and DOES NOT require any further lubrication!

The latch and deadbolt must be lubricated once a year

- ② Hooks, bolts and locking cams as well as the connecting rod below must be lubricated once a year



Lubrication is to be carried out only with lubrication grease or technical vaseline!

③ Split Spindle Pack

To use the split spindle function of the C-TS Door Lock

- a) The male spindle bar retracts the latch and is dedicated as the internal spindle
- b) The female spindle bar operates the multipoint lock but not the latch and is dedicated as the external spindle
- c) Should the door function require reversing remove the handle set and spindles from the door, replace the spindle ensuring that the male spindle bar is on the inside of the door, then replace the handle set

Installation advice

Latch reversal

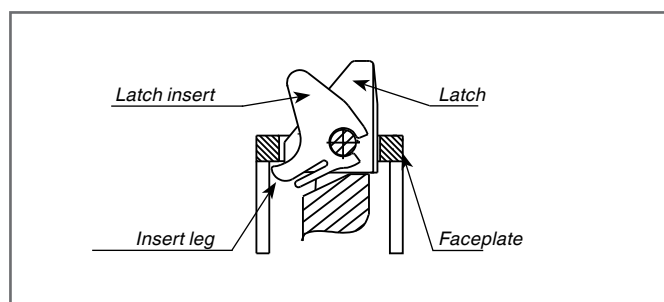
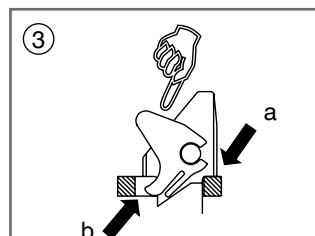
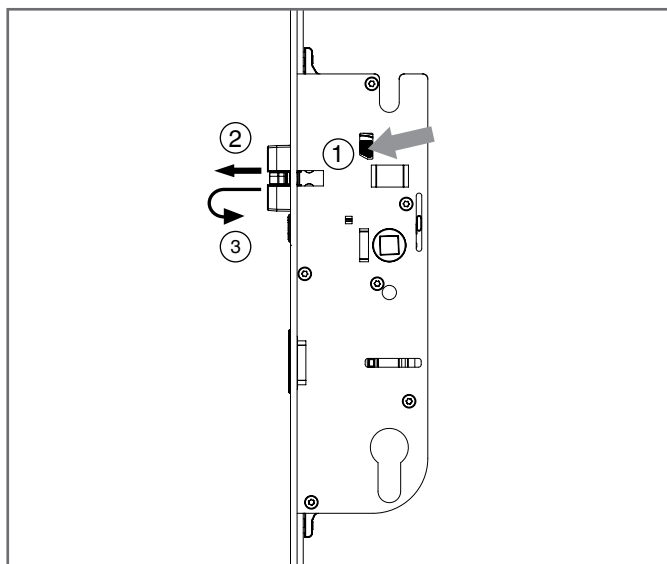

- ① Push up the slider button
- ② Remove the latch
- ③ Reverse the latch and replace it into the faceplate slot, ensuring that the leg on the latch insert locates under the faceplate (b)

Check the latch operation twice!

Installation advice

Latch and deadbolt striker and position

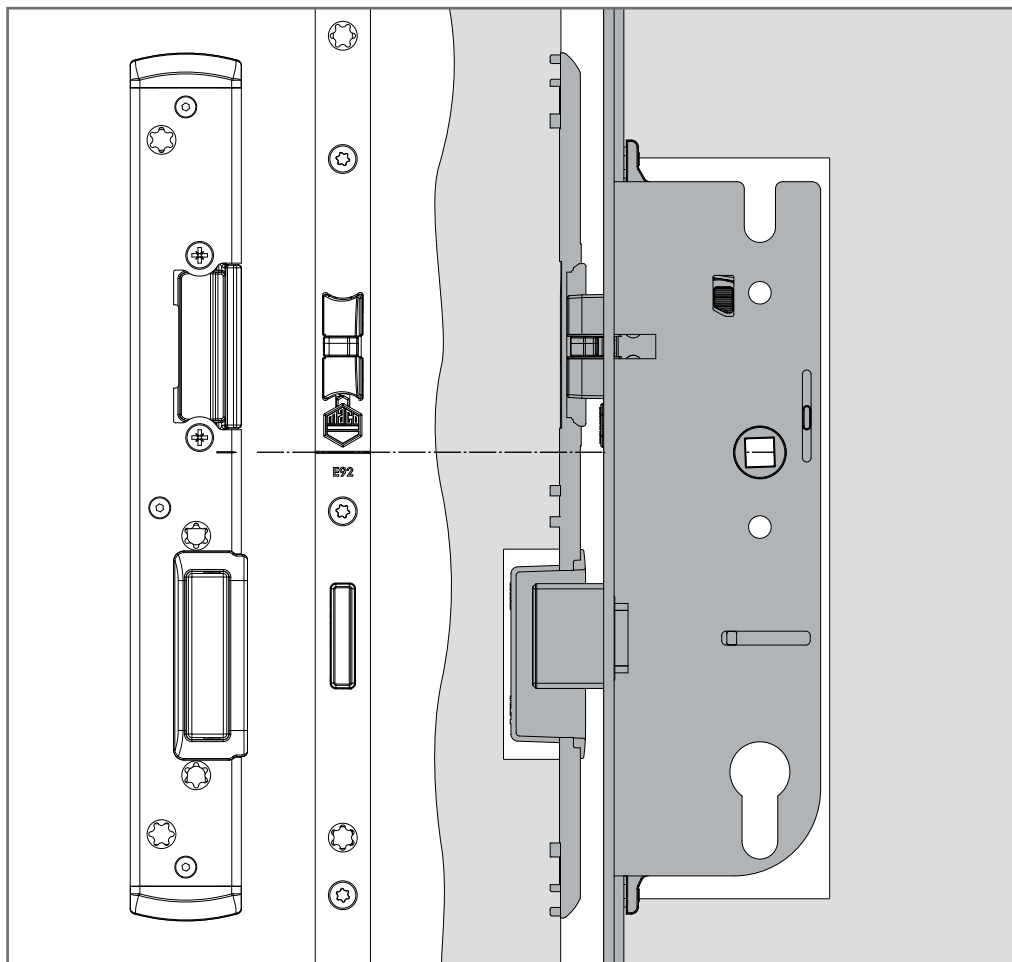

Gasket compression
adjustment
+/- 1 mm

Positioning
Faceplate notch = latch &
deadbolt striker notch

Installation advice

① Positioning the hook and cam striker

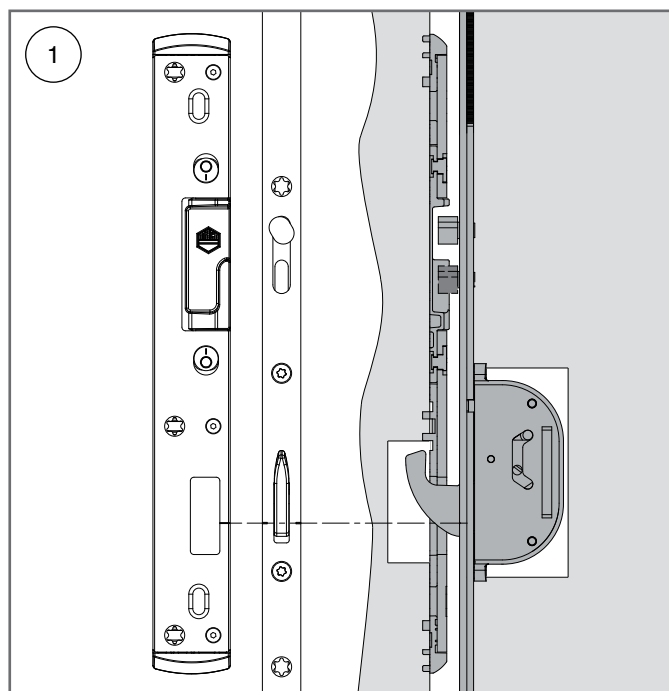

Gasket compression
+/- 1.5 mm

Positioning
Faceplate notch =
striker notch

② Positioning the roller cam striker

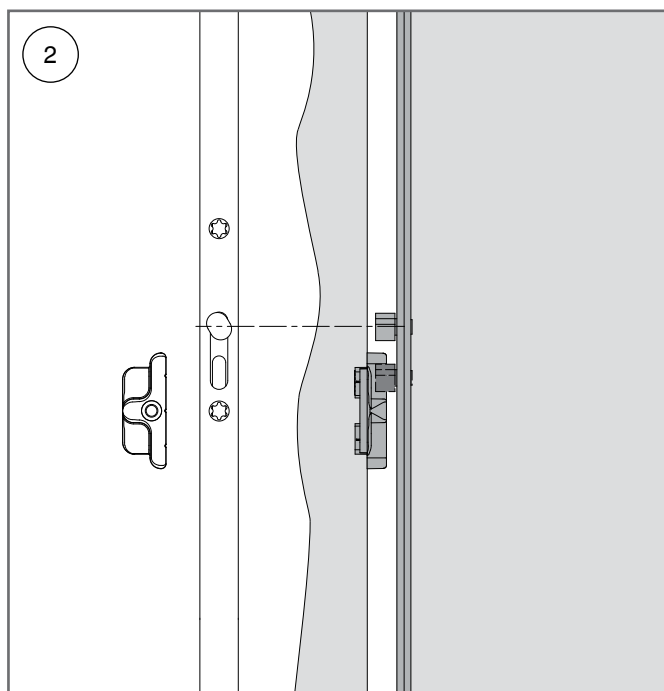

Gasket compression
+/- 0,75 mm

Positioning
Faceplate notch =
striker notch

Routings for main lockcasings Casing routing patterns

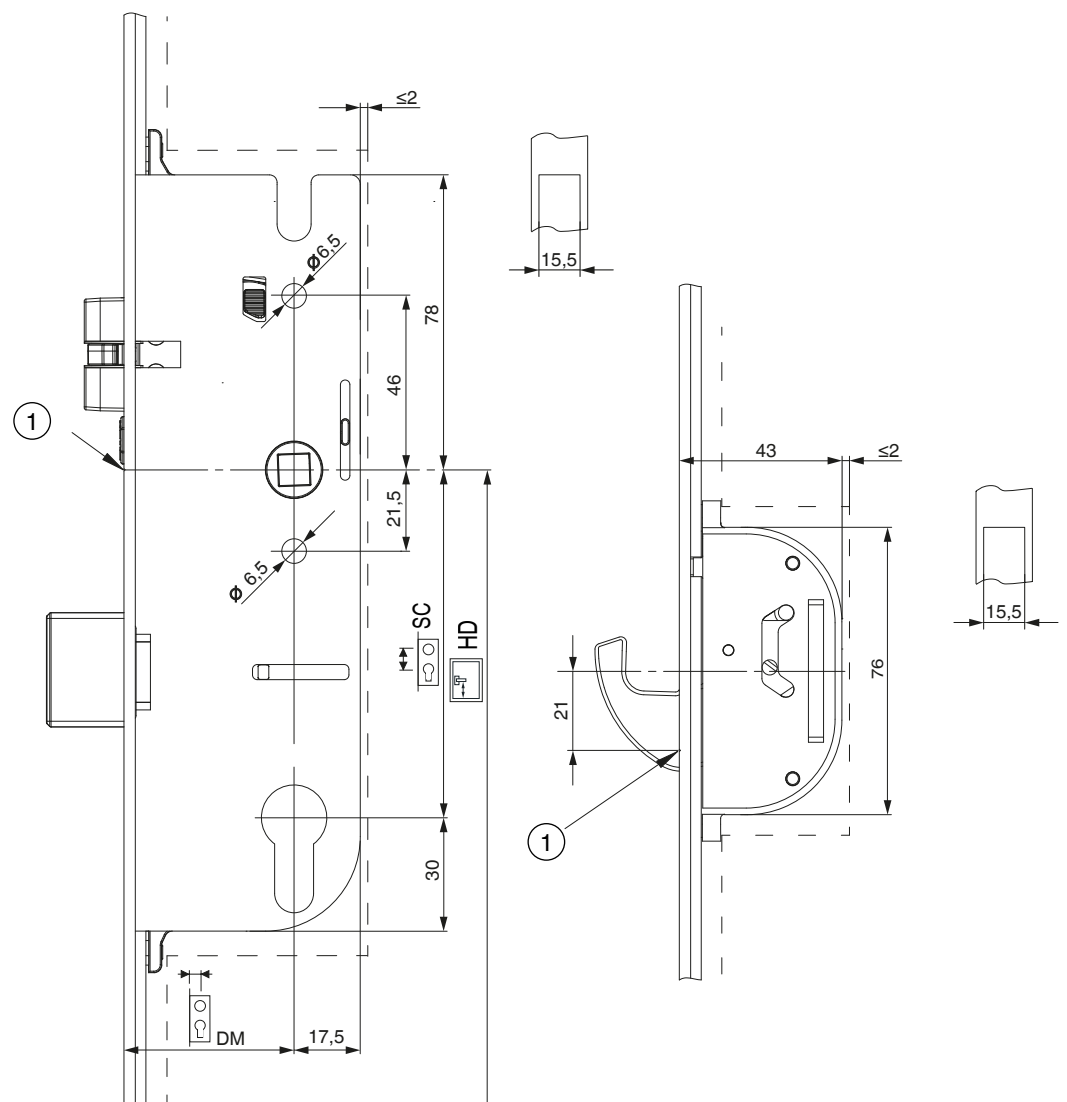

- ① Faceplate notch
- ② Eurogroove

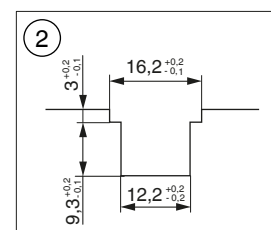

① **Latch and deadbolt striker**



Drilling and routing patterns

① Hook and cam striker

② Roller cam striker

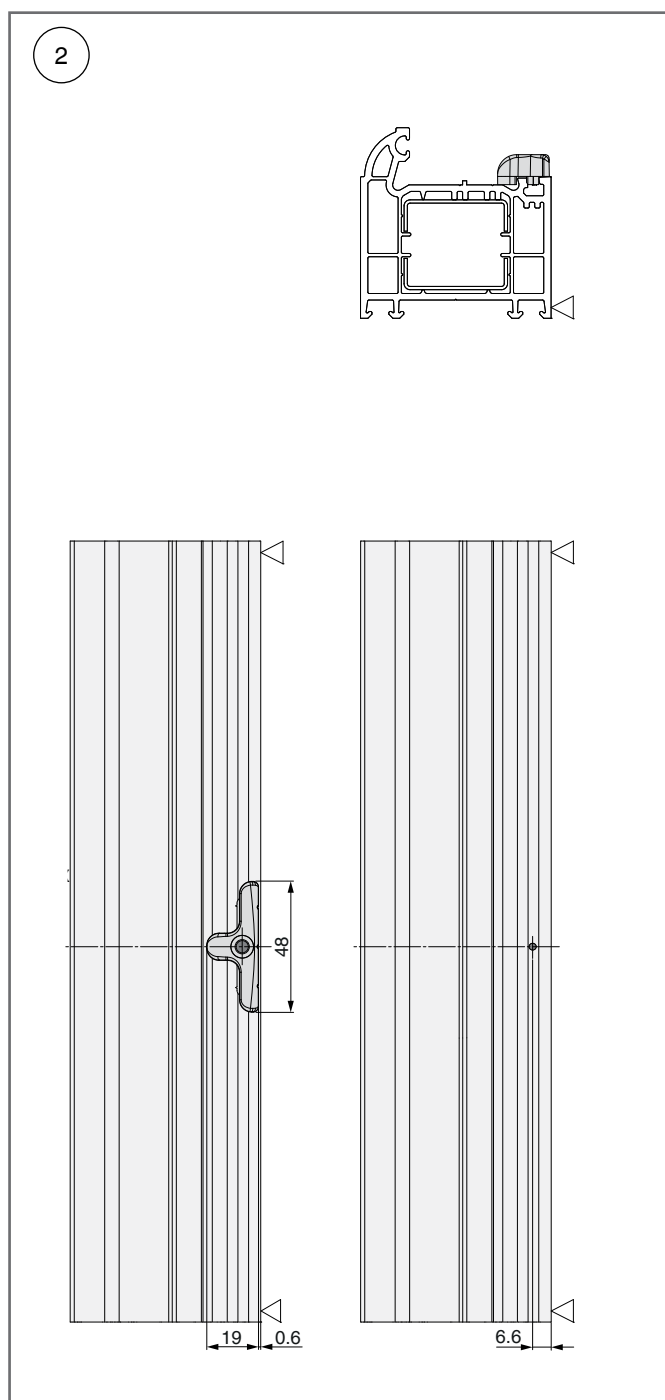
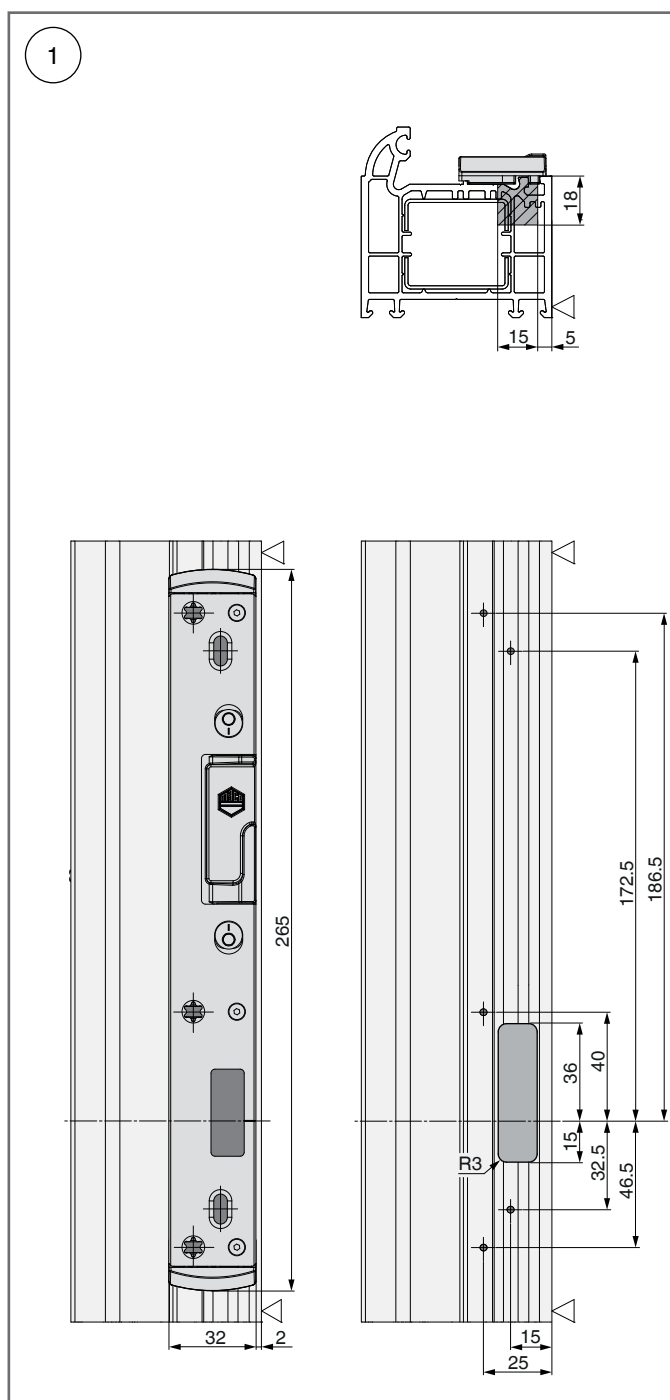



Positioning the strikers

- ① **2 Hook**
- ② **2 Hook and cam combination**

1

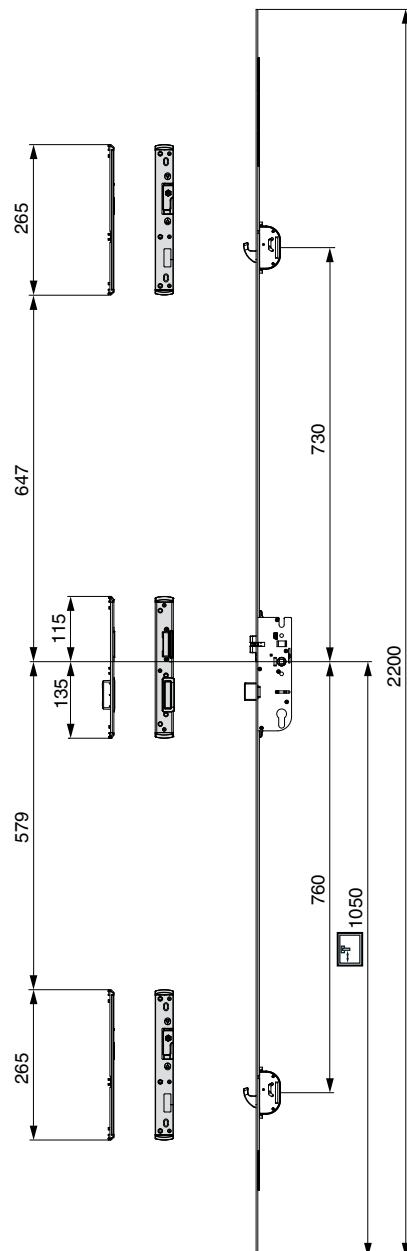

2

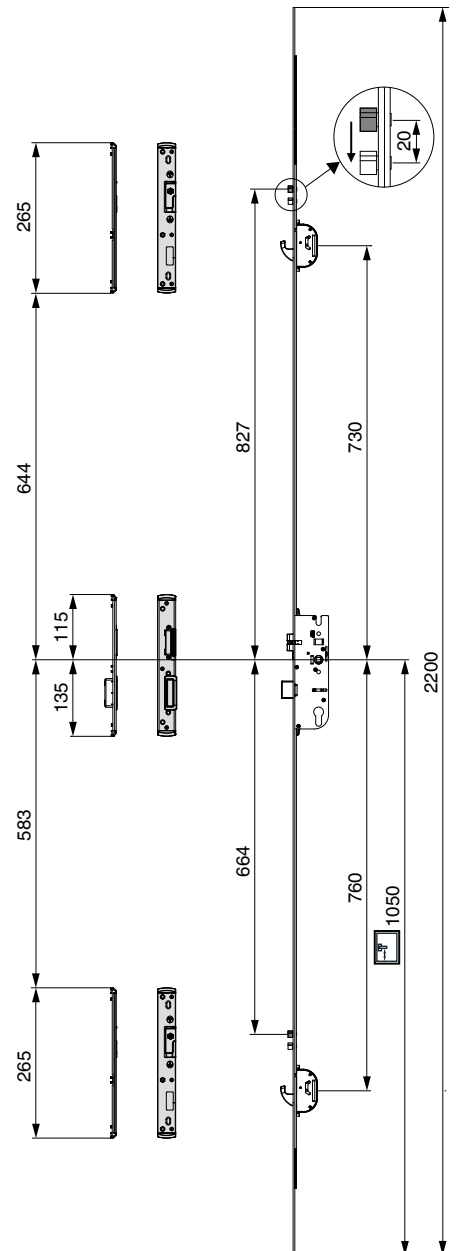



Positioning the strikers

- ③ 2 Hook and cam-combination + 2 roller cams
- ④ 2 Hook and cam-combination
double doors

3

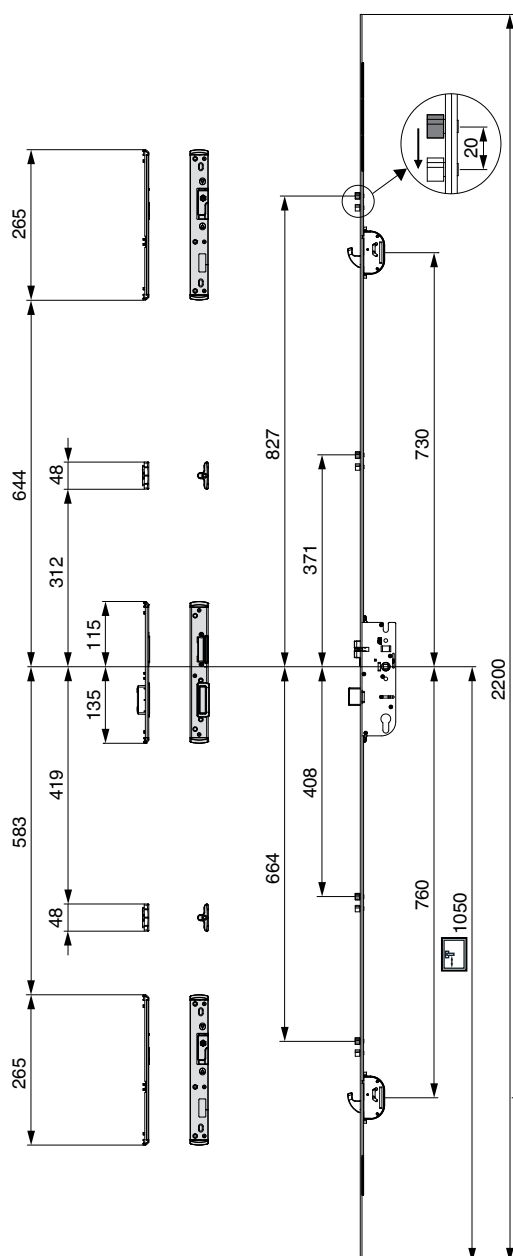

4

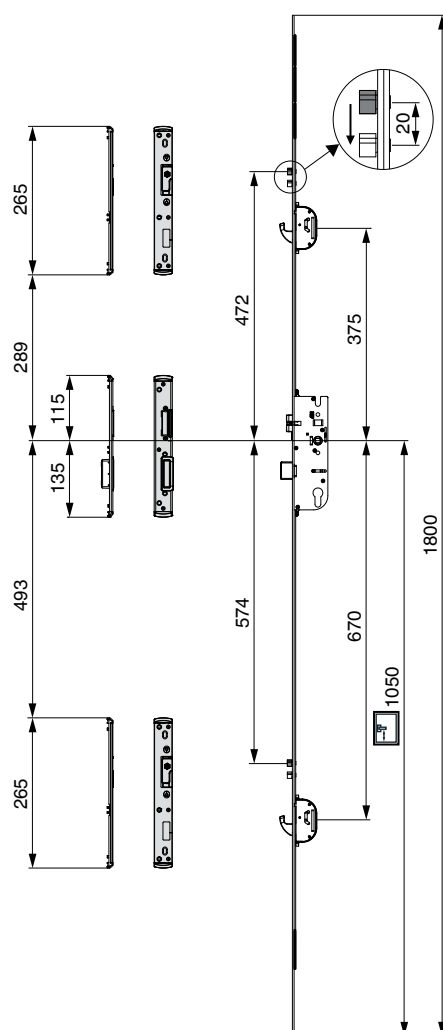

**MACO
PROTECT**



**MACO DOOR & WINDOW
HARDWARE (U.K.) LTD**
CASTLE ROAD, EUROLINK
BUSINESS CENTRE,
SITTINGBOURNE, KENT.
ME10 3LY
TEL +44 (0)1795 433900
FAX +44 (0)1795 433902
enquiry@maco.uk
www.macouk.net



Scan for more Info



Order.-No. 756913_EN - Date: October 2012
All rights reserved and subject to change.