

EN

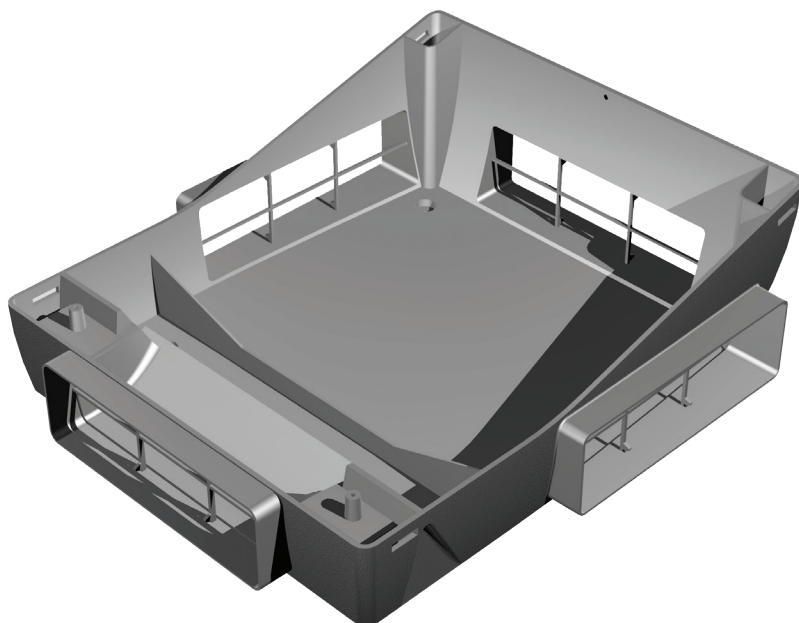

First Fix Base
Product Manual

TP325



 **Titon**[®]
ventilation systems

Warnings, Safety information and Guidance

Important Information

Important: read these instructions fully before the installation of this appliance

1. Installation of the appliance and accessories must be carried out by a qualified and suitable competent person and be carried out in clean, dry conditions where dust and humidity are at minimal levels.
2. All wiring must conform to current I.E.E. Wiring Regulations and all applicable standards and Building Regulations.
3. The appliance must be connected to a local double pole isolation switch with a contact separation of at least 3mm. Ideally located adjacent to the unit.
4. The appliance must be earthed.
5. Separate cables must be used for power and boost control.
6. Units are suitable for 230V ~ 50/60Hz single phase with a fuse rating of 3A.
7. The unit must be stored in a clean and dry environment.
8. Do not install the appliance in areas where the following may be present or occur;
 - Excessive oil or a grease laden atmosphere,
 - Corrosive or flammable gases, liquids or vapours,
 - Ambient temperatures above 40°C or below -5°C,
 - Humidity levels above 90% or is a wet environment.

9. The appliance is not suitable for installation to the exterior of the dwelling.
10. This appliance can be used by children aged from 8 years and above and persons with reduced physical, sensory or mental capabilities or lack of experience and knowledge if they have been given supervision or instruction concerning use of the appliance in a safe way and understand the hazards involved.
11. Children should be supervised to ensure that they do not play with the appliance.
12. Ensure that external grilles are located away from any flue outlet, in accordance with relevant Building Regulations.
13. The unit must not be connected to a tumble dryer.
14. The unit must not be connected to a cooker hood.
15. Precautions must be taken to avoid the back-flow of gases into the room from an open flue appliance.
16. Ensure all ducting, is free from debris and blockages before switching on the unit.
17. Boost & Setback cable - Unshielded 4 Core 18-24AWG Stranded, Tinned Copper; only for - TP303A, TP303HA, TP313CH
18. ALL UNITS, Volt Free & LIVE Boost Switching;
Boost & Setback cables must not be placed within 50mm or on the same metal cable tray as any 230V~ lighting or power cables.

Contents

Warnings, Safety information and Guidance

Important Information	2
-----------------------------	---

Product Overview

Dimensions	6
Component Identification	7
Packaging Contents	7

Installation

Fixing	8
Ducting Connections	9
How to Convert Port Cover	11
Wiring	12
Cable Entry Position	12
CME2 & 2.1 Q Plus TP303A/303HA/TP313A/TP313HA	13
CME2 & 2.1 Q Plus LS TP305HA/TP313HALS	17
CME2.1 Q Plus TP313CH	21

Product Overview

This booklet is required for the first part of a two stage installation of one of the following Units:

- CME2 *Q Plus* TP303A
- CME2 *Q Plus* TP303HA
- CME2.1 *Q Plus* TP313A
- CME2.1 *Q Plus* TP313HA
- CME2 *Q Plus* LS TP305HA
- CME2.1 *Q Plus* LS TP313HALS
- CME2.1 *Q Plus* TP313CH

The installer must be aware which specific model has been specified before commencing installation.

- CME2 & 2.1 *Q Plus* **TP 303A/303HA/TP313A/TP313HA**
- CME2 & 2.1 *Q Plus* LS **TP305HA/TP313HALS**
- CME2.1 *Q Plus* **TP313CH**

have different wiring requirements.

Ensure the correct wiring diagram is used for the installation.

The unit may be damaged if wired incorrectly.

The installer of the second stage will receive further documentation to complete the installation and commissioning.

Dimensions

This diagram details the overall size of the unit and the additional space required around the unit to allow for commissioning and future servicing and maintenance.

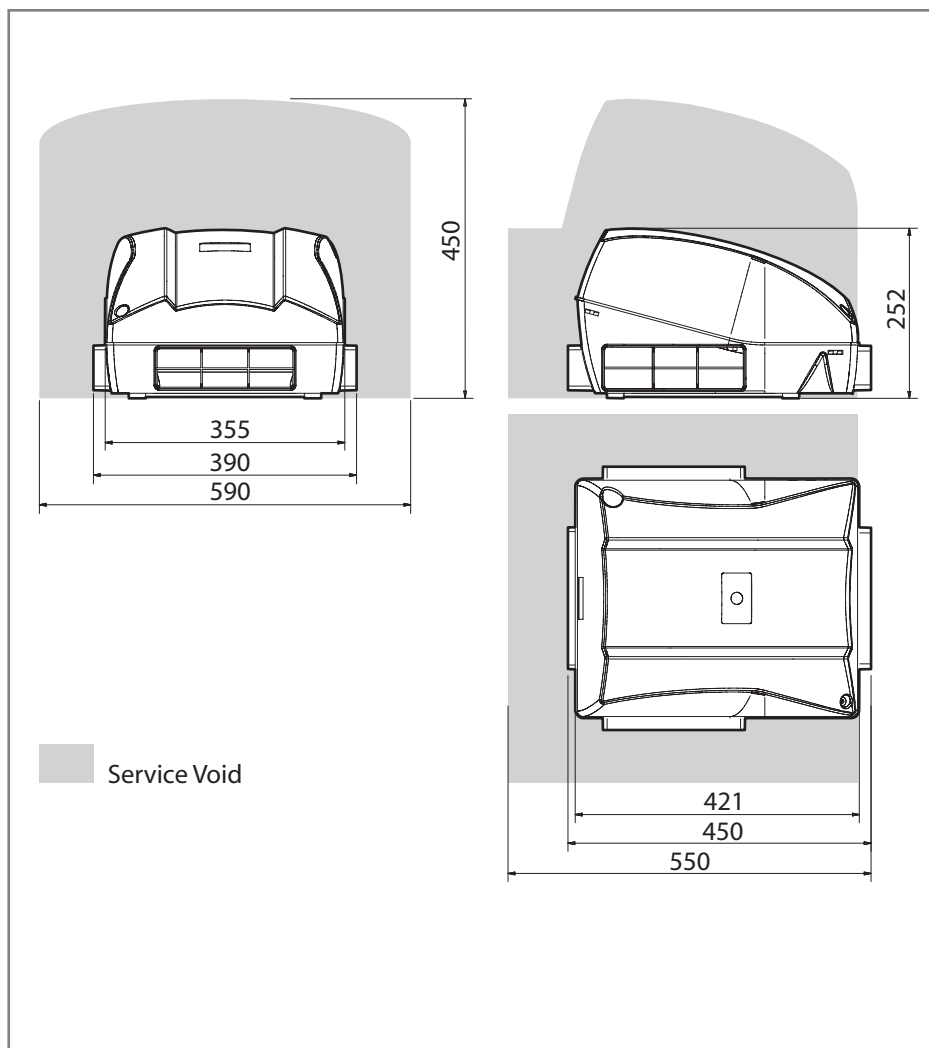

All dimensions in mm

Component Identification

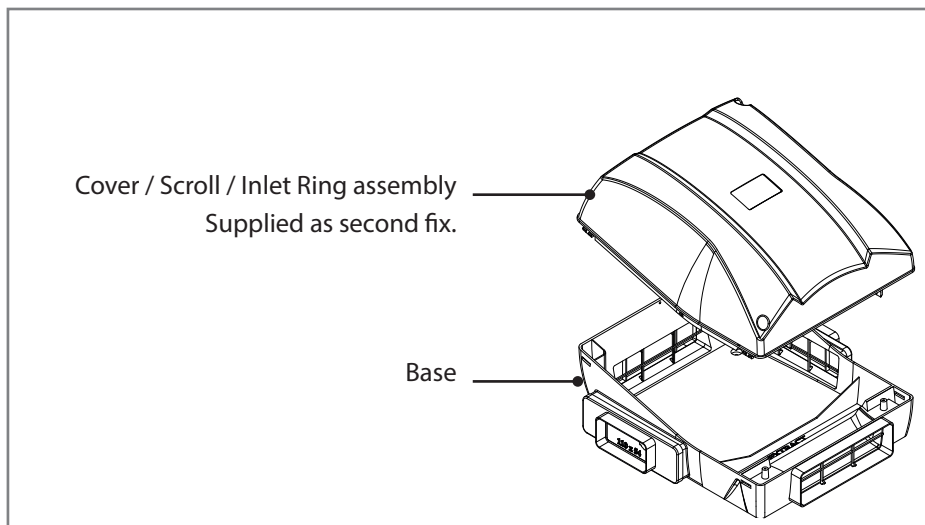

Packaging Contents

Inspect the unit when taking delivery. Check the unit for damage and that all accessories have been supplied. The box contains:

- CME Base x 1.
- Port covers x 3.
- This Product manual x 1.

All shortages or damage must be immediately reported to the supplier.

Installation

Fixing

1. The unit must be securely fixed to a smooth flat surface, any orientation is possible.
2. Mark the four fixing hole centres using the Base as a template.
3. Drill holes for fixings, use 4mm Pan Head screws. Always use a fixing type and length suited to the substrate type. The unit weighs approximately 5kg.
4. Mount the Base, ensuring it is not distorted by the fixings or mounting surface.
5. Clip the Motor and Lid assembly to the Base, ensure that all 6 clips have engaged.

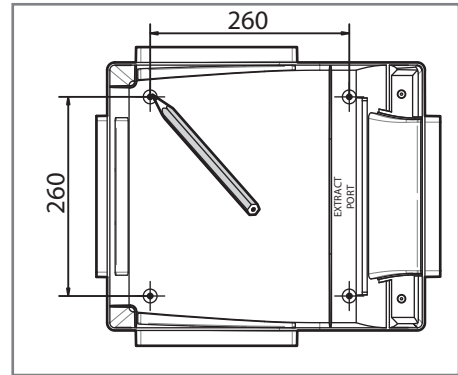

Tighten screws by hand, DO NOT over tighten screws or use power tools.

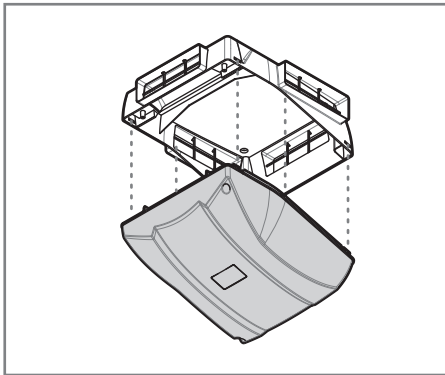

Ducting Connections

Titon recommend the use of guidance given in the Domestic Ventilation



Compliance Guide 2010 Edition ISBN-978 1 85946 378 9 and
Approved Document Part F 2010 ISBN-978 1 85946 370 3 for all
installations in the United Kingdom.

The above documents can be downloaded free from www.planningportal.gov.uk.

Titon recommend that:

1. 204 x 60mm ducting is used for the connection of the Extract Port to Outside.
2. 204 x 60mm or 110 x 54mm ducting is used for connection to the other ports.
3. A minimum distance of 200mm between the CME unit and any sharp bends in duct work.
4. Ducting should be insulated where it passes through unheated areas and voids.
5. Unit should be insulated when fitted in unheated area.
6. Where a duct extends externally above roof level the section above the roof should be insulated or a condensate trap should be fitted just below roof level.
7. Where ducts pass through fire barriers, they must be appropriately fire stopped in accordance with the requirements of Part B Building Regulations (England & Wales).
8. A ducting condensate drain must be fitted to vertical Extract Port to Outside duct work.
9. Condensate drain pipe work must be adequately secured, installed to have a minimum 5° fall and be insulated if any part of the pipe passes through an unheated void.

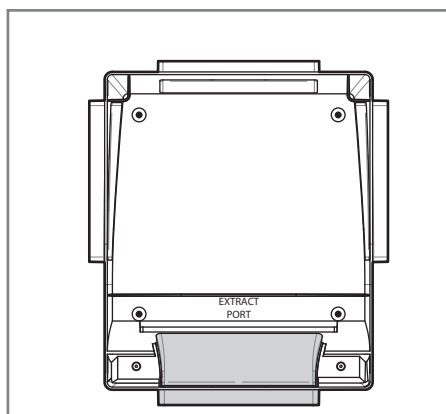

Extract Port to Outside

10. All insulation to be the equivalent of at least 25mm of insulating material with a thermal conductivity of 0.04 W/(mK).
11. Ducting must be installed in such a way that resistance to airflow is minimised.
12. Ducting connected to the Extract Port to Outside must be to the external air outside the building envelope.
13. All ducting joints including those to the CME unit's Duct Ports and Convertible Port Covers must be permanently connected and sealed.
14. Do not distort ducting, Convertible Port Cover or Duct Ports.
15. 204 x 60mm ducting fits inside the units Duct Ports.
16. 110 x 54mm ducting fits inside the Convertible Port Cover.
17. Unused extract ports must be fitted with non-converted or undamaged port covers.

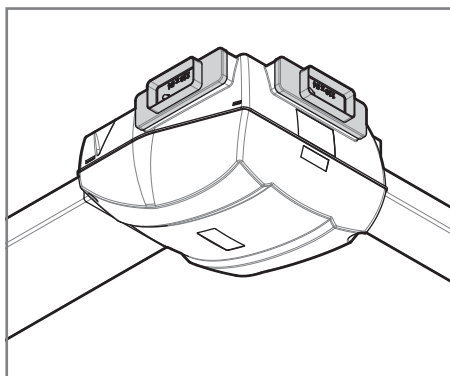
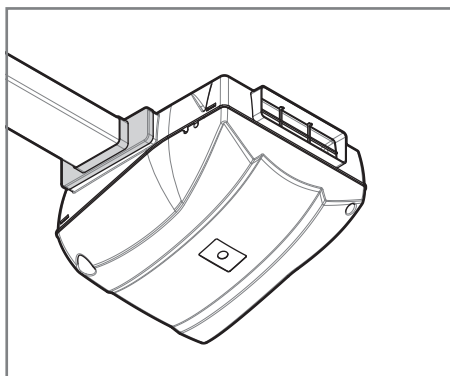
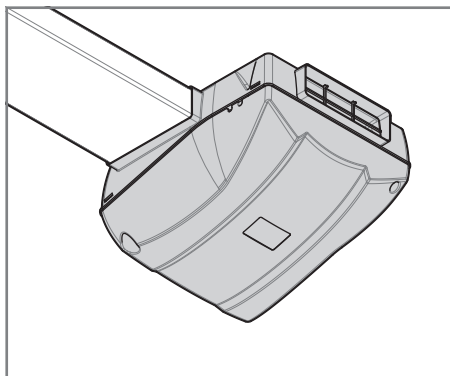

How to Convert Port Cover

1. To enable fitment of 110 x 54mm ducting, modify the Convertible Port Cover by tearing out the 'rip strip'.
2. When using the convertible port cover ensure the tear out section is completely removed.

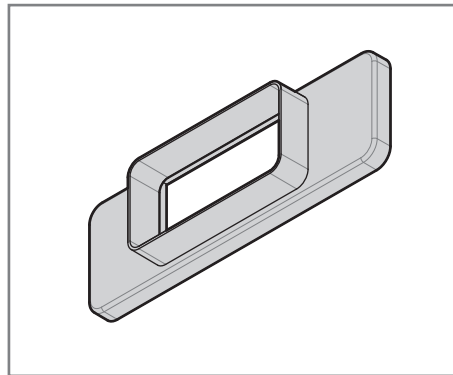
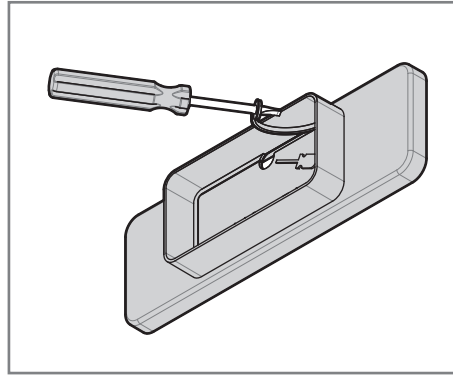

Wiring

The installer must be aware which specific model has been specified before commencing installation of the wiring.

- | | |
|-------------------------------|-------------------------------------|
| ▪ CME2 & 2.1 <i>Q Plus</i> | TP 303A/303HA/TP313A/TP313HA |
| ▪ CME2 & 2.1 <i>Q Plus</i> LS | TP305HA/TP313HALS |
| ▪ CME2.1 <i>Q Plus</i> | TP313CH |

Have different wiring requirements.

Ensure the correct wiring diagram is used for the installation.

The unit may be damaged if wired incorrectly.

The installer of the second stage will receive further documentation to complete the installation and commissioning.

Cable Entry Position

Cable access is via preformed cable entries on the unit's COVER, position arrowed.

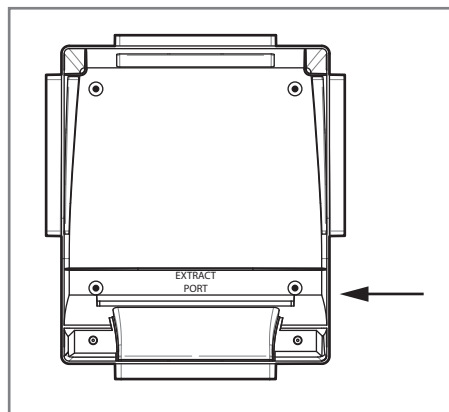

CME2 & 2.1 Q Plus TP303A/303HA/TP313A/TP313HA

Boost & Setback cables must not be placed within 50mm or on the same metal cable tray as any 230V~ lighting or power cables.

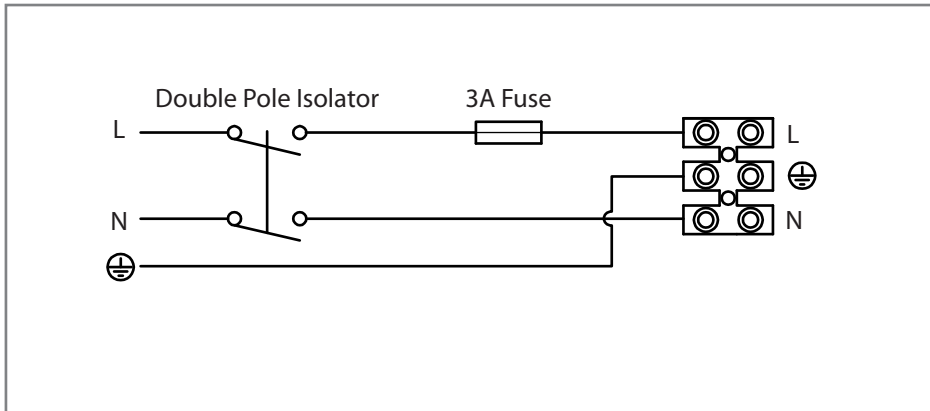

Supply Wiring Diagram 230V~50/60Hz ref EE 141

Volt-free boost switching of CME controller PCB using single-pole switches TP 502, TP 503, TP 507 and/or TP500 / TP501 Humidistat.

There is no limit to the number of single pole switches or humidistats that can be used.

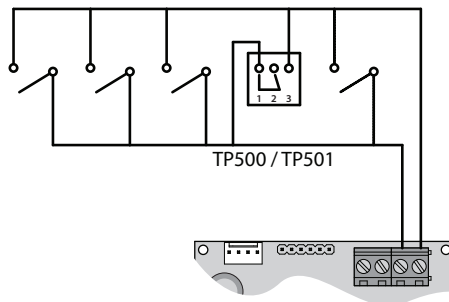

Boost switching and Humidistat connection ref EE 151

Boost & Setback cables must not be placed within 50mm or on the same metal cable tray as any 230V~ lighting or power cables.

Volt-free setback switching of CME controller PCB using single-pole latching switch and / or volt-free normally open relay contacts.

To avoid the unit being inadvertently left in Setback Mode, it is recommended that only one latching switch is fitted.

Volt-free setback switch or normally open relay contacts

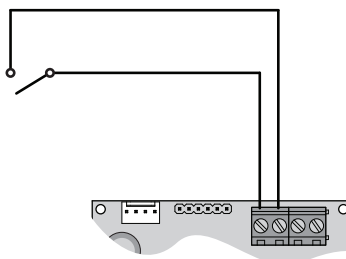

Setback Switch connection ref EE 152

SWITCH POSITIONS

- 1 - Setback Speed
- 2 - Continuous Speed
- 3 - Boost Speed

TP 508
Three position rotary switch

U3 U2 U1 L

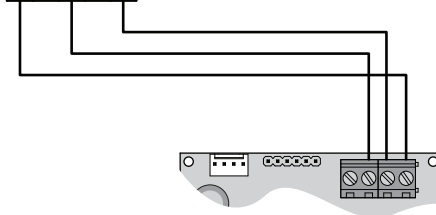

Three position Rotary Switch TP 508 switching and connection ref EE 153

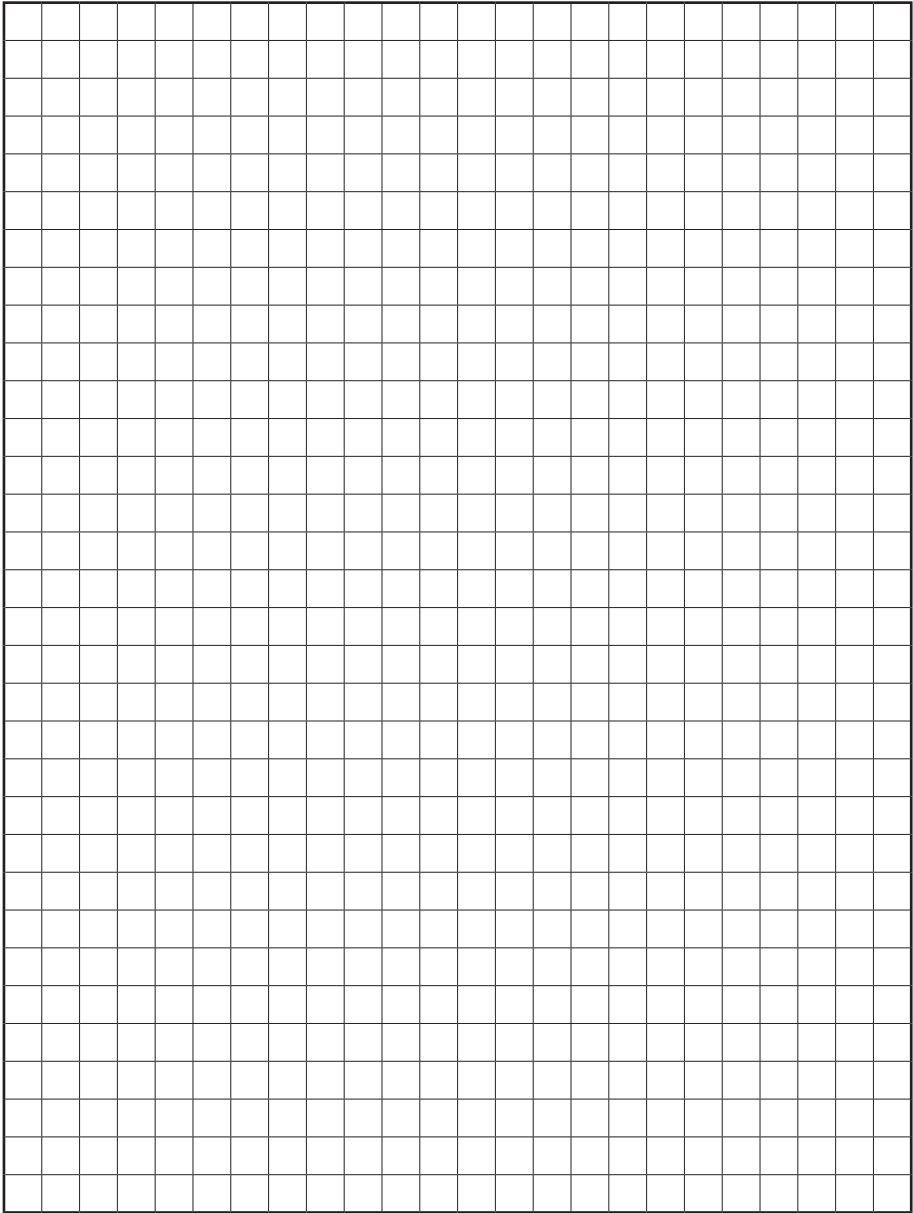

The installer must be aware which specific model has been specified before commencing installation of the wiring.

- | | |
|-------------------------------|-------------------------------------|
| ▪ CME2 & 2.1 <i>Q Plus</i> | TP 303A/303HA/TP313A/TP313HA |
| ▪ CME2 & 2.1 <i>Q Plus</i> LS | TP305HA/TP313HALS |
| ▪ CME2.1 <i>Q Plus</i> | TP313CH |

Have different wiring requirements.

Ensure the correct wiring diagram is used for the installation.

The unit may be damaged if wired incorrectly.

The installer of the second stage will receive further documentation to complete the installation and commissioning.

Cable Entry Position

Cable access is via preformed cable entries on the unit's COVER, position arrowed.

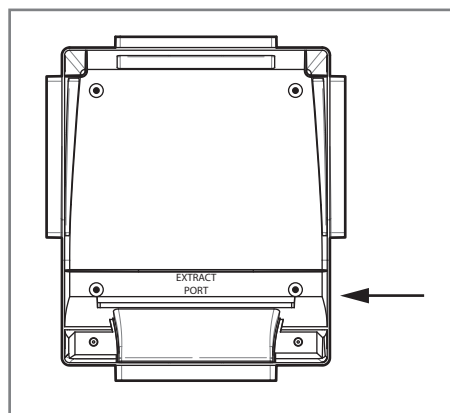

CME2 & 2.1 Q Plus LS TP305HA/TP313HALS

Boost & Setback cables must not be placed within 50mm or on the same metal cable tray as any 230V~ lighting or power cables.

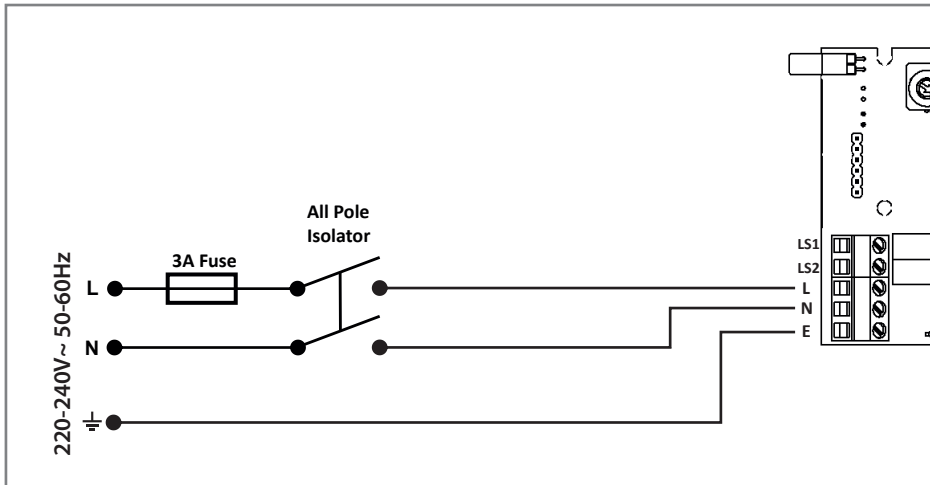

Supply Wiring Diagram 220-240V~ 50-60Hz ref EE 184

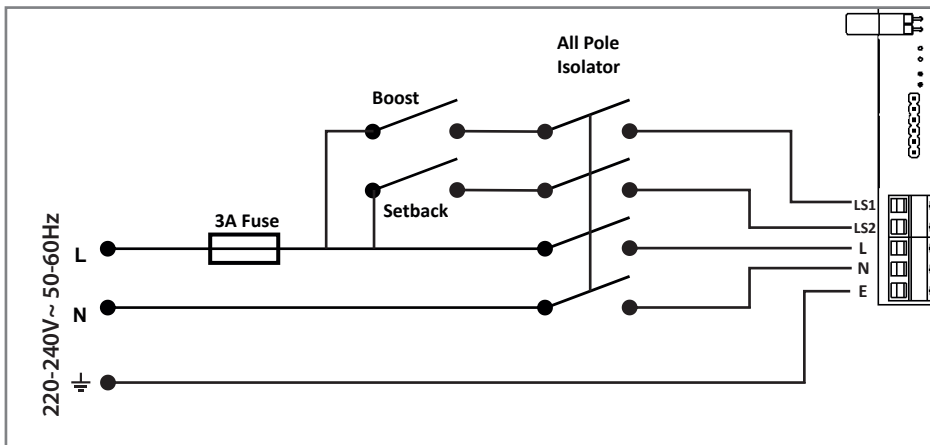

Boost and Setback switching ref EE 186

Boost & Setback cables must not be placed within 50mm or on the same metal cable tray as any 230V~ lighting or power cables.

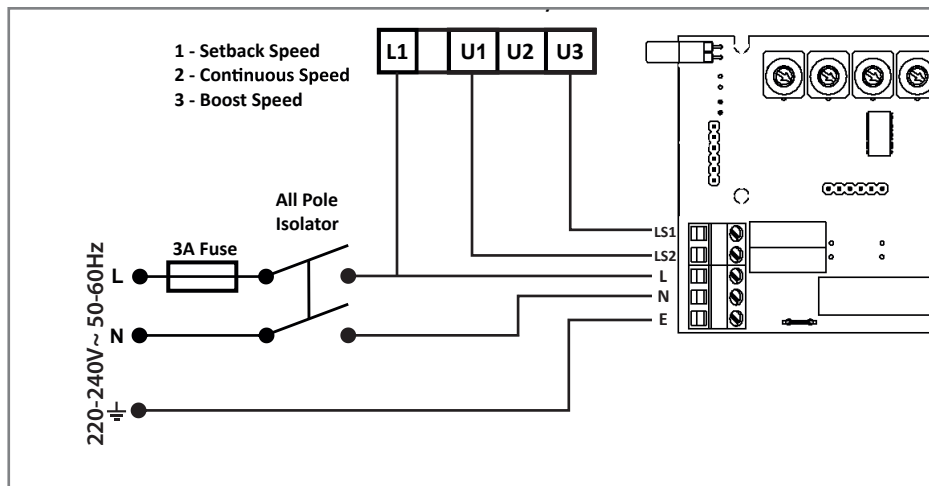

Three position Rotary Switch TP 508 switching and connection ref EE 185

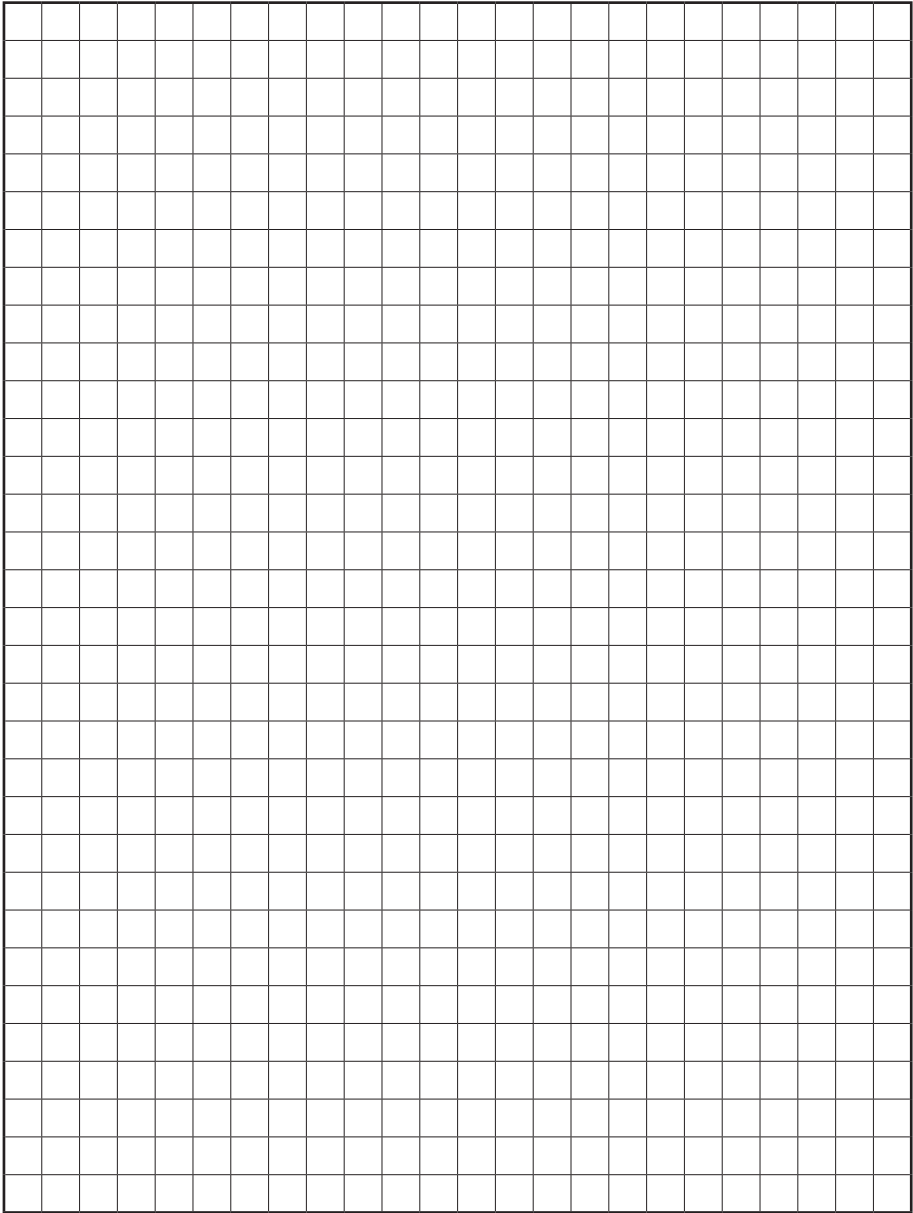

The installer must be aware which specific model has been specified before commencing installation of the wiring.

- | | |
|-------------------------------|-------------------------------------|
| ▪ CME2 & 2.1 <i>Q Plus</i> | TP 303A/303HA/TP313A/TP313HA |
| ▪ CME2 & 2.1 <i>Q Plus</i> LS | TP305HA/TP313HALS |
| ▪ CME2.1 <i>Q Plus</i> | TP313CH |

Have different wiring requirements.

Ensure the correct wiring diagram is used for the installation.

The unit may be damaged if wired incorrectly.

The installer of the second stage will receive further documentation to complete the installation and commissioning.

Cable Entry Position

Cable access is via preformed cable entries on the unit's COVER, position arrowed.

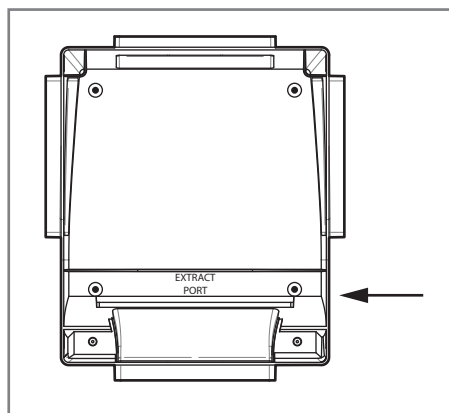

CME2.1 Q Plus TP313CH

Boost & Setback cables must not be placed within 50mm or on the same metal cable tray as any 230V~ lighting or power cables.

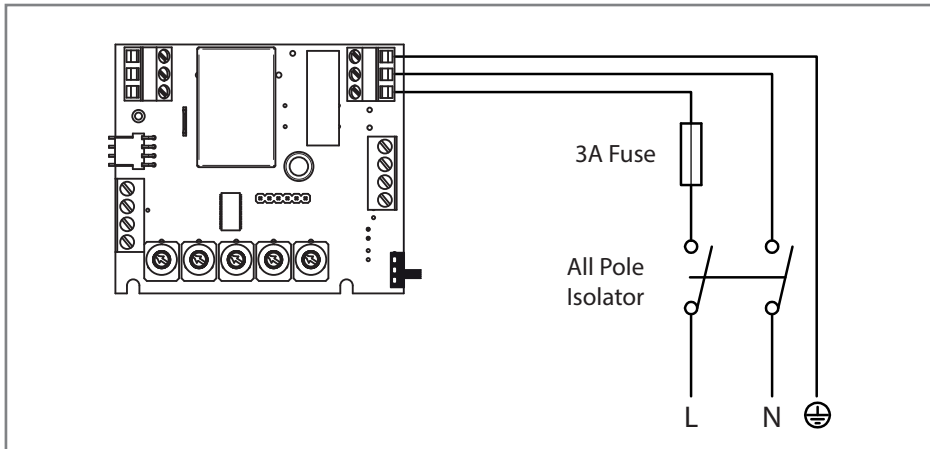

Supply Wiring Diagram 230V~50/60Hz

Volt-free boost switching of unit's controller PCB using single-pole switches TP 502, TP 503, TP 507 and/or TP500 / TP501 Humidistat.

There maximum of 10 single pole switches or humidistats that can be used.

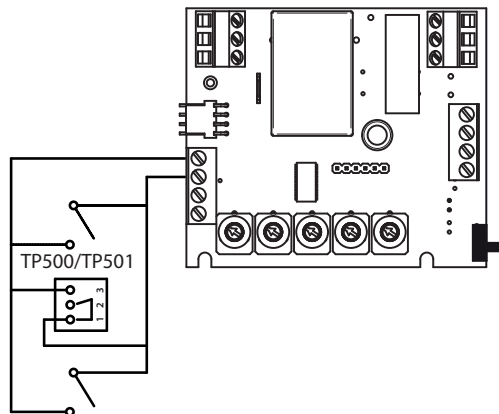

Boost switching and External Humidistat connection

Boost & Setback cables must not be placed within 50mm or on the same metal cable tray as any 230V~ lighting or power cables.

Volt-free setback switching of the unit's controller PCB using single-pole latching switch and / or volt-free normally open relay contacts

To avoid the unit being inadvertently left in Setback Mode, it is recommended that only one latching switch is fitted.

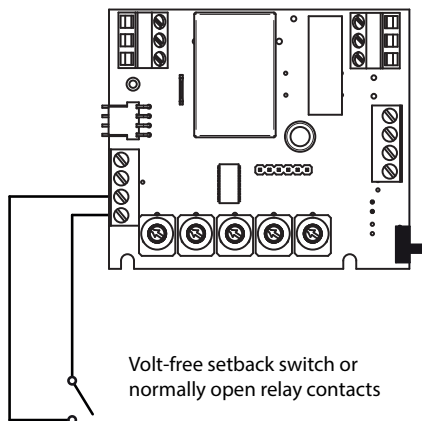

Setback Switch connection

SWITCH POSITIONS

- 1 - Setback Speed
- 2 - Continuous Speed
- 3 - Boost Speed

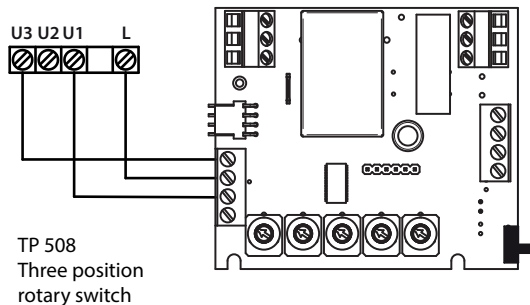

Three position Rotary Switch TP 508 switching and connection

Boost & Setback cables must not be placed within 50mm or on the same metal cable tray as any 230V~ lighting or power cables.

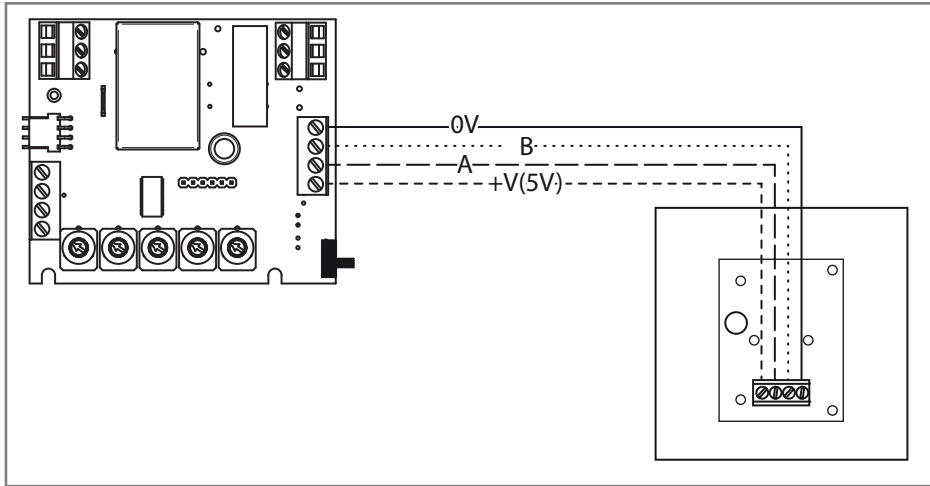

Connection of auralite

Installed by



Important environmental information about this product.

This symbol on this unit or the package, indicates that disposal of this unit after its lifecycle could harm the environment. Do not dispose the unit as unsorted municipal waste; it should be disposed by a specialized company for recycling. This unit should be returned to your distributor or to a local recycling service. Respect the local environmental rules. If any doubt contact your local authorities about waste disposal rules.

In the event of any queries please contact the system installer. Ensure this booklet is passed to the householder once installation and commissioning of the ventilation system is complete. This Product Manual must be kept in the Home Information Pack.



MARKETING DIVISION

894 The Crescent, Colchester Business Park, Colchester, CO4 9YQ

Tel: +44 (0) 1206 713800 **Fax:** +44 (0) 1206 543126

Email: ventsales@titon.co.uk **Web:** www.titon.com